

# Commercial Sale For Sale

- 1501 Venera Ave, Coral Gables, Florida 33146



**PARK PLACE CENTRE II**

**FOR LEASE**  
Park Place Centre  
1501 Venera Ave, Coral Gables FL

**Aerial Photo of Neighborhood**

- Prime A+ Location
- Mediterranean Architecture
- Walking Distance to Whole Foods, Publix & RedTulip Shopping Area
- Directly Across from Riviera Park
- Covered & Uncovered Assigned Parking
- Ample Street Parking
- 24 hr. Building Access
- Professionally Managed

**Space Available**  
282 rsf available now

**FOR LEASING INFORMATION CONTACT:**  
Research Management Corporation  
1501 Venera Ave, Suite 201  
Coral Gables, FL 33134  
(305) 443-8061  
rmc@costantinirealty.com

**RMC**  
Real Estate Management, Leasing and Sales Specialists  
Commercial Real Estate Division

© 2012 Research Management Corporation. All rights reserved. Reproduction or representation in any form is prohibited without the express or implied consent of Research Management Corporation. This document is for informational purposes only and does not constitute an offer of any financial product or service. All information is subject to change without notice.

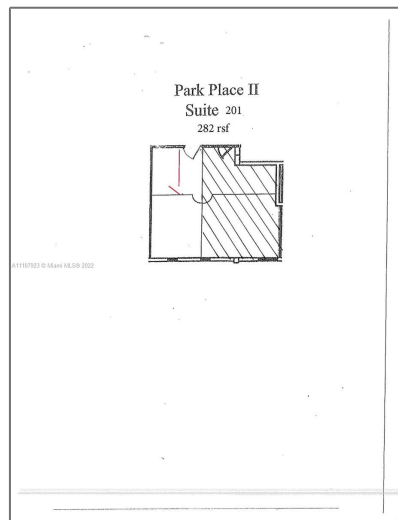

## Basic

Property Type: **Commercial Sale**

Listing Type: **For Sale**

Listing ID: **A11107923**

Price: **\$1,295**

Year Built: **1981**

Lot Area: **31,603 Sqft**

## Address

Country: **US**

State: **FL**

County: **Miami-Dade County**

City: **Coral Gables**

Zipcode: **33146**

Street: **1501 Venera Ave**

Floor Number: **0**

## Agent



Svetlana Costantini

📞 954-459-5268

✉️ svetlana@costantinirealty.com

✉️ igor@costantinirealty.com

